

Application Notes

Resistor Terminals for Tubular Cores

TYPE 57

Std. on .313 (7.950mm) O.D. cores. Also used on cores from .250 (6.350mm) to .750 (19.050mm) O.D. Solder coated. Terminal bolts not available.

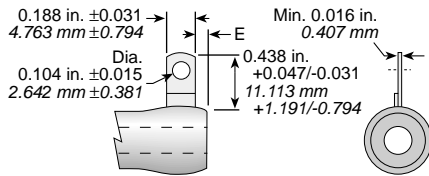

TYPE 40 AND 40A

Std. on .563 (14.300mm), .750 (19.05mm) and 1.000 (25.40mm) O.D. cores. Also used on cores from .313 (7.950mm) to 1.125 (28.575mm) O.D. Solder coated. Type 40A has screw #6-32 x .5 (12.70mm) with 2 nuts and 2 washers.

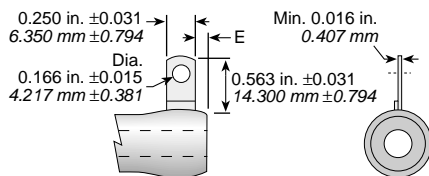

TYPE 46 AND 46A

Std. on 1.125 (28.575mm) O.D. cores. Also used on cores .563 (14.300mm) to 1.50 (38.10mm) O.D. Solder coated. Type 46A has screw #8-32 x .625 (15.875mm) with 2 nuts and 2 washers.

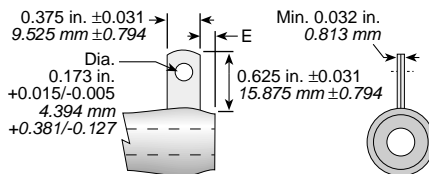

TYPE 44 — 44A — 45 — 45A — 45B

Type 44 std. on 1.50 (38.10mm) to 2.50 (63.50mm) cores. Also used on cores from .75 (19.05mm) to 1.125 (28.575mm) O.D. Solder coated. Type 44A has screw #20 x .625 (15.875mm) with 2 nuts and 2 washers. Type 45A has screw #8-32 x .625 (15.875mm) with 2 nuts and 2 washers. Type 45B has screw #10-32 x .625 (15.875mm) with 2 nuts and 2 washers.

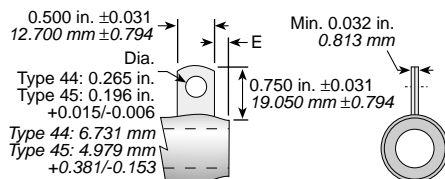

TYPE 47 AND 48

.125 (3.175mm) on .313 (7.950mm) O.D. cores and larger with #18 ga. leads .0625 (1.588mm) on .250 (6.35mm) O.D. cores and smaller, #20 ga. leads. Type 47 leads 2.00 (50.80mm) long. #20 ga. Type 48 leads 1.500 (38.10mm) long. Leads solder coated. Used on cores .210 (5.25mm) to .563 (14.3mm) O.D.

E = .016 (.407mm) on cores less than 1.00 (25.40mm) long.
.031 (.788mm) on cores 1.00 (25.40mm) and longer.

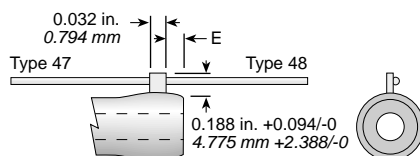

TYPE 48R

Dimensions and lead gauge same as Type 48.

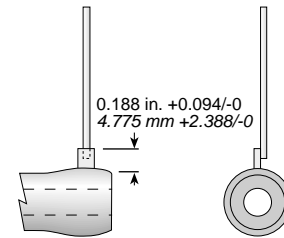

TYPE 58

Designed for printed circuit board use. Used on cores .210 (5.334mm) O.D. to .562 (14.275mm) O.D. Leads #20 ga. solder coated.

E = .016 (.407mm) on cores less than 1.00 (25.40mm)
.031 (.788mm) on cores 1.00 (25.40mm) thru 2.00 (50.80mm).

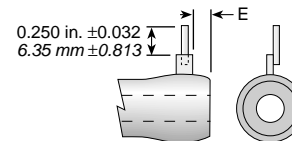

TYPE 126 AND 126R

Used on cores .313 (7.950mm) to 1.125 (29.575mm) O.D. Leads #18 ga. stranded bare phosphor bronze. Specify length.

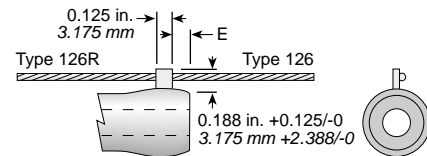

TYPE 532

Quick connect terminal used on .313 (7.950mm) thru 1.125 (28.575mm) O.D.

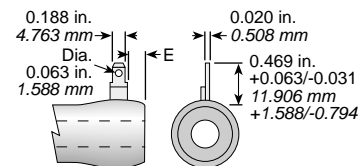

TYPE 538

Quick connect terminal used on .313 (7.950mm) thru 2.50 (63.50mm).

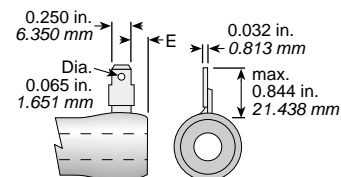

TYPE 535

Dual quick connect terminal used on .313 (7.950mm) thru 2.50 (63.50mm).

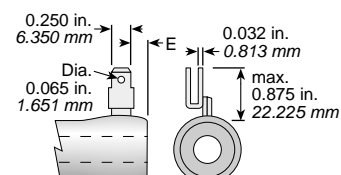

Application Notes

Resistor Terminals for Tubular Cores

OTHER TERMINALS

Type 49

.250 (6.35mm) wide x
.313 (7.950mm)
.166 (4.217mm) dia.
hole. Solder coated.

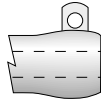

Type 51

.125 (3.175mm) wide
x height as specified.
.072 (1.829mm) hole.
Solder coated.

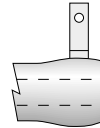

Type 68

.188 (4.775mm) wide
x .531 (13.488mm)
high. Solder coated.

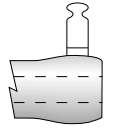

Type 50

Untinned lug intended for
welded connection.
.063 (1.600mm) x height
as specified.

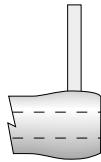

Type 52

For "wire wrap" (Keller,
Gardner-Denver T.M.)

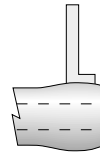

Type 69

.125 (3.175mm) wide
x .375 (9.525mm)
high. Solder coated.

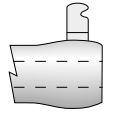

EDGE DISTANCE—DIMENSION "E"

Terminals	Core O.D.																			
	in.	mm	in.	mm	in.	mm	in.	mm	in.	mm	in.	mm	in.	mm	in.	mm	in.	mm	in.	mm
40-40A-49-50-	.250	6.350	.313	7.938	.438	11.113	.563	14.288	.750	19.050	1.00	25.40	1.125	28.575	1.500	38.100	1.625	41.275	2.500	63.500
57-68-69-126-126R-532	.031	.794	.094	2.381	.094	2.381	.094	2.381	.125	3.175	.156	3.969	.219	5.556	—	—	—	—	—	—
44-44A-45-45A-45B-46-46A	—	—	—	—	—	—	.250	6.350	.250	6.350	.250	6.350	.250	6.350	—	—	—	—	—	—
535-538	—	—	.125	3.175	.125	3.175	.125	3.175	.125	3.175	.156	3.969	.219	5.556	.250	6.350	.250	6.350	.500	12.700

Dimension "E" can be varied and is often reduced for cores 2.00 (50.80mm) or less in length or sometimes increased for greater leakage distance to ground. Tolerance on "E" is $\pm .016$ (.397mm) up to .125 (3.175mm) and $\pm .063$ (1.588mm) above.

TYPE 140

For Cores .438 (11.113mm) to 1.125 (28.575mm) O.D.

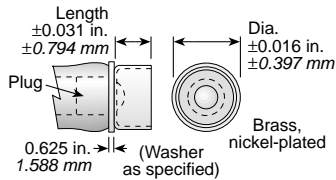

Ferrule				Catalog No.	
Diameter In.	mm	Length In.	mm	No Washer	With Washer
.563	14.288	.500	12.700	140/9*	140/19
.688	17.463	.563	14.288	140/11*	140/01
.813	20.638	.500	12.700	140/13†	140/03
1.125	28.575	.500	12.700		140/18

* Up thru .563 (14.288mm) D core.

† Up thru .750 (19.050mm)

TYPE 146

For Cores as Required

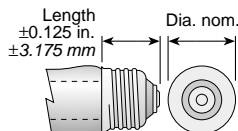

Cat. No.	Size	Diameter		Length	
		In.	mm	In.	mm
146/I	Intermediate	.656	16.669	.813	20.638
146/M	Medium	1.031	26.194	1.000	25.400

Miniature and Candelabra bases also available.

TYPE 141

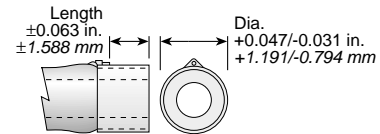

Ferrule				Catalog No.	Core O.D.	
Diameter In.	mm	Length In.	mm		In.	mm
.625	15.875	.625	15.875	141/10	.563	14.288
.813	20.638	.688	17.463	141/13	.750	19.050
1.062	26.988	.688	17.463	141/17	1.000	25.400
1.188	30.163	.688	17.463	141/19	1.125	28.575

Ferrules are brass, natural finish.

TYPE 63

Cores .563 (14.288mm) to .750 (19.050mm) O.D. -----Cat No. 63/12

Cores 1.000 (25.400mm) to 1.125 (28.575mm) O.D. ----Cat No. 63/18

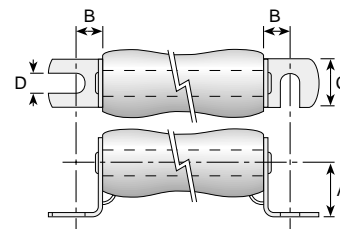

Cat. No.	A		B		C		D (Min.)	
	In.	mm	In.	mm	In.	mm	In.	mm
63/12	.781	19.844	.438	11.113	.750	19.050	.250	6.350
63/18	.875	22.225	.813	20.638	1.125	28.575	.313	7.938